



Reviewed for Code Compliance  
Inspection Division  
Approved with Conditions

Date: 05/16/14

BEARING WALL SCHEDULE (U.N.O.)	
1W	2x4's @ 24" o.c.
2W	2x4's @ 24" o.c. + 1-2x4's @ 48" o.c.
3W	2x4's @ 12" o.c.
4W	2x4's @ 12" o.c. + 1-2x4 @ 24" o.c.
5W	2-2x4's @ 12" o.c.
6W	2x4's @ 16" o.c.
7W	2x6's @ 24" o.c.
8W	2x6's @ 24" o.c. + 1-2x6 @ 48" o.c.
9W	2x6's @ 16" o.c.
10W	2x6's @ 12" o.c.
11W	2x8's @ 12" o.c.

NOTE:

1. ALL STUDS TO BE SPF NO.1/NO.2 OR BETTER.
2. ALL NON BEARING PARTITIONS TO BE 2x4's @ 24" o.c. U.N.O.
3. ALL EXTERIOR WALLS ARE BEARING WALL 6W U.N.O. ON PLAN.
4. ALL INTERIOR BEARING WALLS ARE 3W UNLESS NOTED ON PLAN.

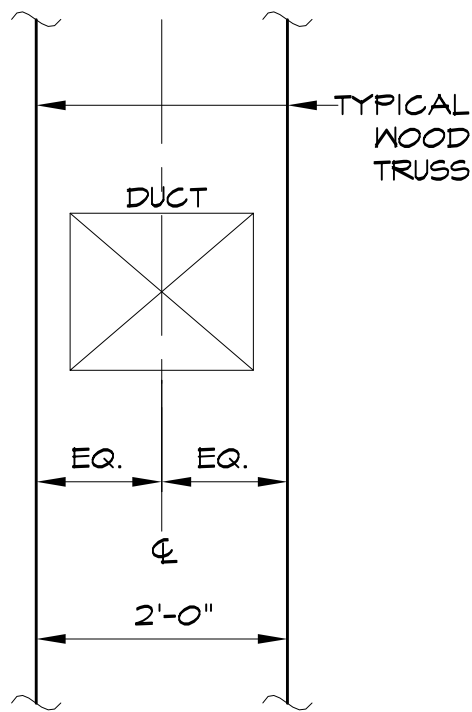

TYPICAL TRUSS LAYOUT  
@ MECHANICAL UNITS

NOTE:

ALL MET WALLS TO BE 2x6  
WALL PANELIZER TO COORD.  
ALL MET WALL LOCATIONS  
WITH ARCHITECT.

NOTE:

TRUSS MFG. TO COORDINATE FLOOR  
TRUSS SPACING W/MECHANICAL UNITS.  
MECHANICAL UNIT TO BE CENTERED  
BETWEEN 2-FLOOR/ROOF TRUSSES.

WOOD TRUSS LOAD SCHEDULE		
ROOMS:	LIVE LOAD	40 psf
	TOP CHORD DEAD LOAD	35 psf
	BOTTOM CHORD DEAD LOAD	5 psf
	TOTAL	80 psf
CORRIDORS	LIVE LOAD	40 psf
	TOP CHORD DEAD LOAD	25 psf
	BOTTOM CHORD DEAD LOAD	5 psf
	TOTAL	70 psf
ROOF	LIVE/SNOW LOAD	35 psf + allow for drift
	TOP CHORD DEAD LOAD	15 psf
	BOTTOM CHORD DEAD LOAD	5 psf
	TOTAL	55 psf
PRIVATE ROOF DECK	LIVE/LOAD	40 psf + allow for drift
	TOP CHORD DEAD LOAD	20 psf
	BOTTOM CHORD DEAD LOAD	5 psf
	TOTAL	65 psf

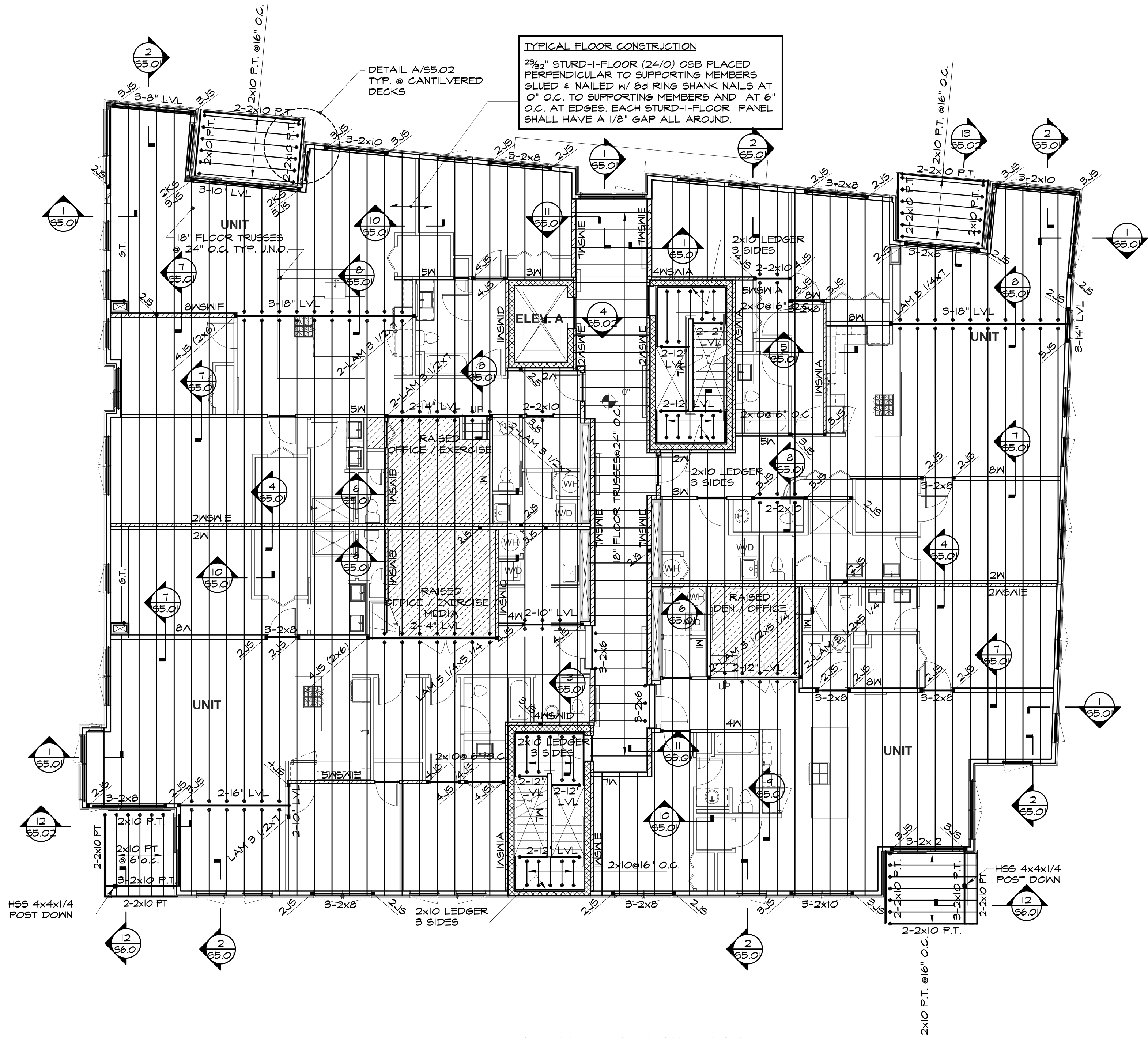

THIRD FLOOR FRAMING PLAN  
1/8"=1'-0"

FLOOR FRAMING NOTES:

1. FOR TYPICAL DETAILS AND GENERAL NOTES SEE DRAWINGS S2.01 TO S2.03.
2. FOR PLATE HEIGHT, SEE ARCHITECTURAL DRAWINGS.
3. GENERAL CONTRACTOR NOTE: REFER TO ROOF AND FLOOR PLANS FOR LOCATIONS OF POSTS AND JACK STUDS. POSTS AND JACK STUDS SHALL EXTEND DOWN CONTINUOUSLY TO THE FOUNDATION WALL UNLESS INTERRUPTED BY A BEAM OR JACK STUDS. AT ALL JACK STUD AND POST LOCATIONS PROVIDE MATCHING BLOCKING STUDS BELOW FIRST FLOOR SHEATHING DOWN TO FOUNDATION WALL OR LVL BEAMS.
4. FRAMING SUPPLIER SHALL SUBMIT WOOD TRUSS AND LVL HANGER INFORMATION FOR APPROVAL.
5. X-6" LVL INDICATES THE NUMBER OF 1 3/4" x 5 1/2" LVL'S.  
X-8" LVL INDICATES THE NUMBER OF 1 3/4" x 7 1/4" LVL'S.  
X-10" LVL INDICATES THE NUMBER OF 1 3/4" x 9 1/2" LVL'S.  
X-12" LVL INDICATES THE NUMBER OF 1 3/4" x 11 3/8" LVL'S.  
X-14" LVL INDICATES THE NUMBER OF 1 3/4" x 14" LVL'S.  
X-16" LVL INDICATES THE NUMBER OF 1 3/4" x 16" LVL'S.
6. "6T" INDICATES GIRDER TRUSS.
7. "R=" INDICATES HANGER LOAD.
8. "XKS" INDICATES THE NUMBER OF FULL HEIGHT KING STUDS.
9. "XJS" INDICATES THE NUMBER OF JACK STUDS.
10. "xxxPSL" INDICATES PARALLAM POST SEE PLAN.
11. \* INDICATES TOP CHORD BEARING TRUSSES.
12. INDICATES FLUSH FRAMING WITH HANGERS OR TOP CHORD BEARING FLUSH FRAMING.
13. INDICATES TRUSSES/JOISTS CONTINUOUS OVER WALLS/HEADERS.
14. INDICATES POINT LOAD ON WOOD TRUSS OR GIRDER TRUSS.
15. ALL HEADERS IN 6" WALLS SHALL BE 3-2x8 UNLESS NOTED OTHERWISE.
16. ALL HEADERS IN 4" WALLS SHALL BE 2-2x10 UNLESS NOTED OTHERWISE.
17. AT EXTERIOR WALLS PROVIDE 1 JACK STUD AT END OF EACH OPENING AND UNDER CONCENTRATED LOAD UNLESS NOTED OTHERWISE. AT INTERIOR WALLS PROVIDE 2 JACK STUDS AT EACH END OF THE OPENING AND UNDER CONCENTRATED LOAD, UNLESS NOTED OTHERWISE.
18. INDICATES 2x... BEARING WALLS BELOW, SEE BEARING WALL SCHEDULE FOR SIZE & SPACING OF WALL STUDS.
19. AT ALL INTERIOR AND EXTERIOR LOAD BEARING WALLS OVER 8'-0" IN HEIGHT, PROVIDE ONE ROW OF WOOD BLOCKING AT MID-HEIGHT OF STUDS.
20. "SAW", "SHEAR WALL" OR INDICATES SHEAR WALL.
21. FOR SHEAR WALL ELEVATIONS AND DETAILS, SEE DRAWING S3 SERIES DWGS.
22. SHEAR WALL ANCHORS SHALL BE PROVIDED AT THE ENDS OF EACH SHEAR WALL. POSITIVE ANCHORAGE SHALL BE CONTINUOUS THROUGH ALL FLOOR LEVELS AND MUST TERMINATE AT FOUNDATIONS. FOR ANCHOR REQUIREMENTS, SEE SHEAR WALL ELEVATION.
23. FOR PIPES HUNG BELOW CORRIDORS, ATTACH PIPE HANGERS AT MID-HEIGHT OF JOISTS.
24. SEE LOAD SCHEDULE FOR FLOOR JOISTS DESIGN LOADS.
25. TRUSS SUPPLIER TO COORDINATE LOCATION AND SIZE OF MECHANICAL CHASES WITH MEP DRAWINGS.
26. PROVIDE POST CAPS AT ALL POST COLUMNS TO SECURE POSTS TO GIRDER TRUSSES OR LVL'S.
27. WHERE TRUSS FALLS DIRECTLY BELOW WATER CLOSET, MOVE TRUSS 6" AND ADD AN ADDITIONAL TRUSS TYPICAL.
28. IN SWI A INDICATES BEARING/SHEAR WALL TYPE. SEE SCHEDULE ON DWG S3 SERIES DWGS.  
 HOLDDOWN  
 SHEAR WALL  
 BEARING WALL

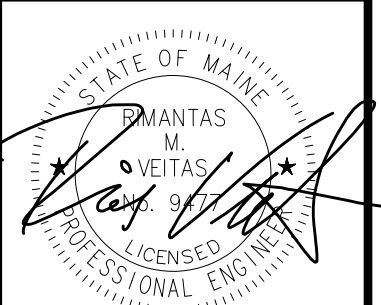

Prepared For:  
**118 on Munjoy Hill, LLC**  
118 CONGRESS STREET  
PORTLAND, ME 04101

Consultant:  
**VEITAS VEITAS**  
engineers  
689 Grand Street, Suite 200  
Bangor, ME 04401  
TEL: (207) 845-5983 FAX: (207) 845-5985

Architect:  
**ARCHETYPE**  
architects  
48 Union Wharf Portland, Maine 04101  
(207) 772-6022 Fax (207) 772-4056

Project:  
**118 ON MUNJOY HILL**  
118 CONGRESS STREET  
PORTLAND, MAINE

Revisions:  
**100% CONSTRUCTION DOCUMENTS**

Date: 5 MAR 2014  
Scale: As indicated  
**THIRD FLOOR FRAMING PLAN**

**S1.03**